

88 4551 95 Kitchen Cart

IMPORTANT NOTE

Carefully remove all the parts from the carton and put them individually on a soft cloth to prevent scratches or other damages occurring to the wood parts.

We have taken great care in the design of this product and request that you carefully and strictly follow our assembly instructions to ensure a completed product as it was designed.

Home
Styles



PART LIST



A.
Top
1 pc.

B.
Side Panel
1 pc.

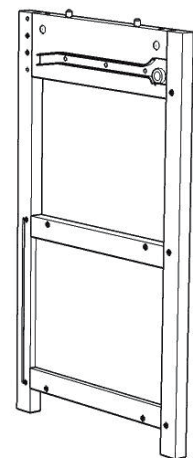

C.
Side Panel
1 pc.

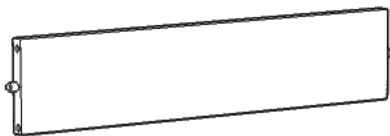

D.
Back Stretcher
1 pc.



E.
Front Piece
1 pc.

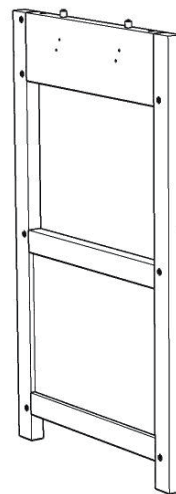

F.
Fixed Shelf
1 pc.

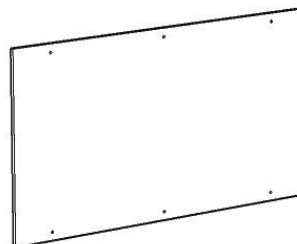

H.
Back Panel
1 pc.

I.
Door
1 pc.

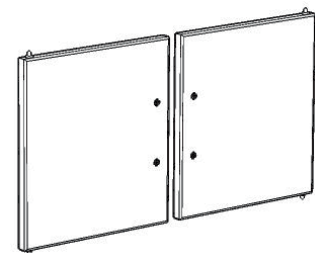

J.
Door
1 pc.

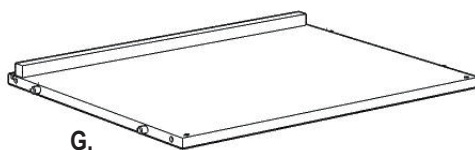

G.
Base
1 pc.

K.
Drawer
1 pc.

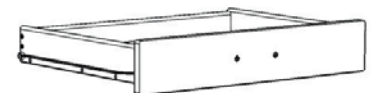

(Please refer to the last page of these instructions for drawer assembly steps.)

HARDWARE LIST



Caster
2 lock
2 non-lock
4 pcs.



Magnet
2 pcs.



Cross Dowel
4 pcs. (+1 extra)



Cam Lock Screw
4 pcs. (+2 extra)



**M3x16
Wood Screw (short)**
for Drawer Base Part
and Back Panel
12 pcs. (+1 extra)



Hook
2 pcs.



**Drawer
Pull Handle**
3 pcs.



**M3x16
Wood Screw**
for Magnet
4 pcs. (+1 extra)



**M3x38
Wood Screw**
10 pcs. (+1 extra)



**M6x51
Bolt**
4 pcs. (+1 extra)



Cam Lock
4 pcs. (+4 extra)



**M3.5x25
Wood Screw (long)**
for Drawer Side Part
8 pcs. (+1 extra)



**M3x16
Wood Screw**
for Hook
4 pcs. (+1 extra)



**M4x22
Machine Screw**
6 pcs.



Wood Plug
14 pcs.

Tools required for assembly : **Phillips** screwdriver

Home Styles Consumer Assistance: www.homestyles-furniture.com,
servicedesk@homestyles-furniture.com, 888-680-7460, 877-831-0319

IMPORTANT

- * Do not tighten up all the screws until each part is properly assembled.
- * Use a soft cloth between these parts and the floor.

STEP 1

Attach 2X Magnets to Fixed Shelf (F) by using Wood Screws (for Magnet) into the pre-drilled holes. (See Figure 1)

Attach Back Stretcher (D), Front Piece (E), Fixed Shelf (F) and Base (G) to Side Panel (B) with Wood Screws, Bolts and Cross Dowels.

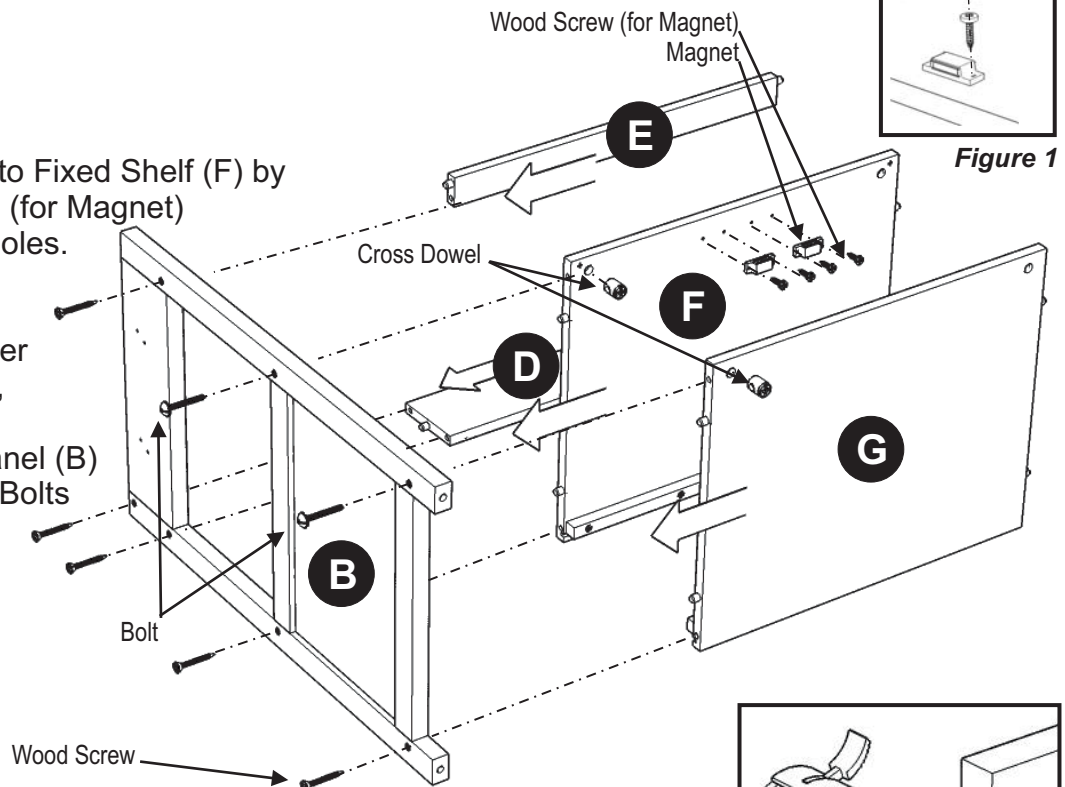

Figure 1

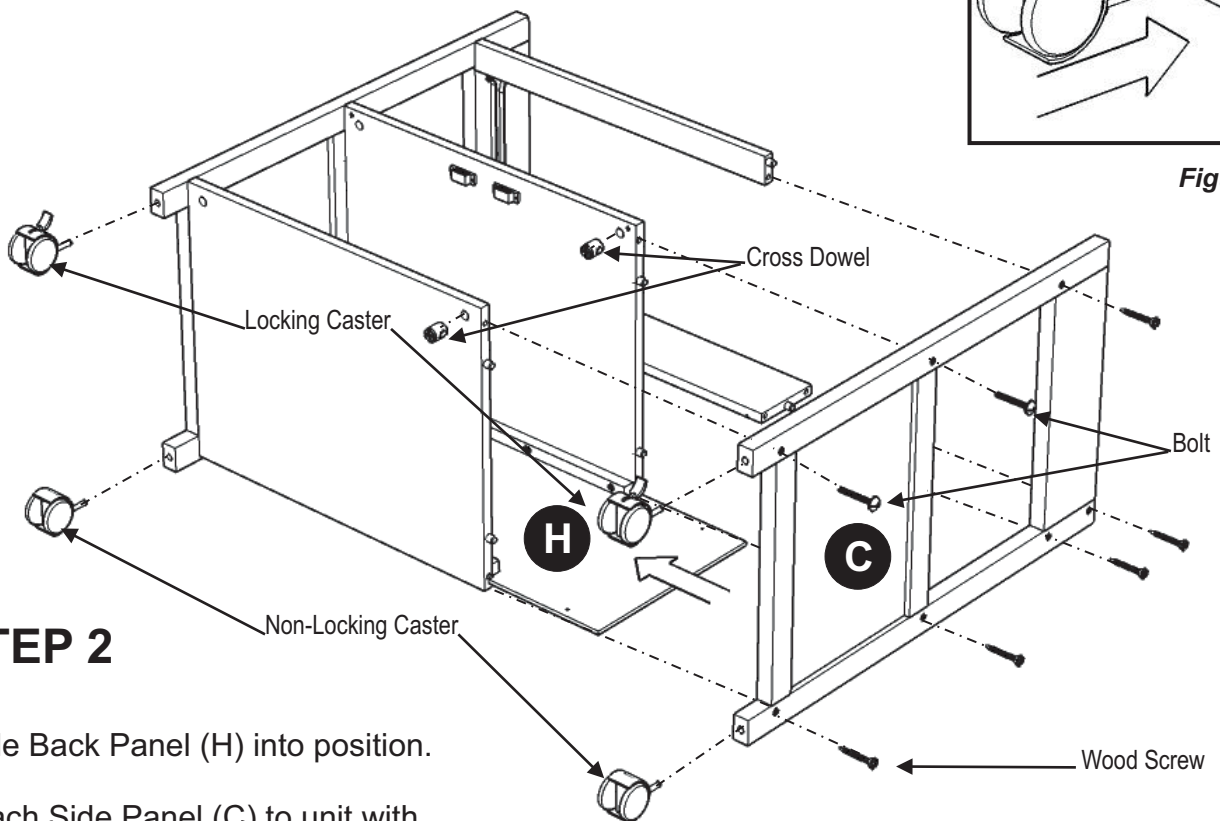

Figure 2

STEP 2

Slide Back Panel (H) into position.

Attach Side Panel (C) to unit with Wood Screws, Bolts and Cross Dowels.

Attach 2 Locking and 2 Non-Locking Casters to bottom of Side Panels (B) and (C). (See Figure 2)

STEP 3

Place Top (A) upside down on a soft cloth.

Insert Cam Lock Screws into the pre-drilled holes of Top (A).
(See Figure 3)

Cam Lock Screw

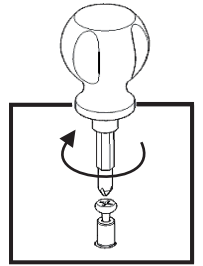
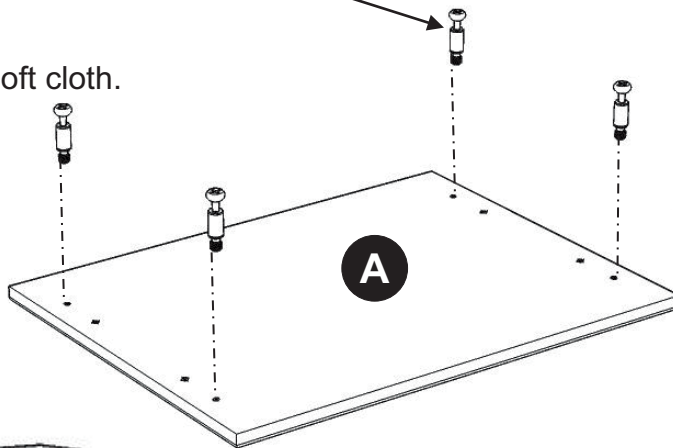
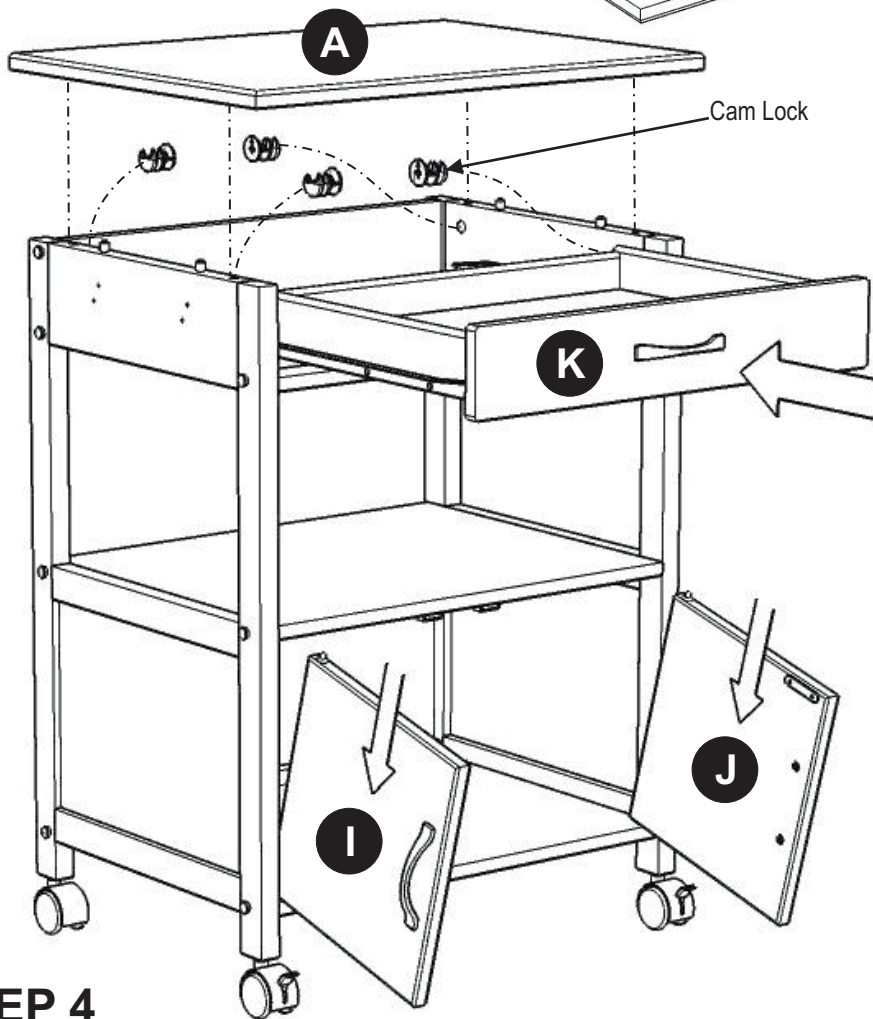

Figure 3



Cam Lock

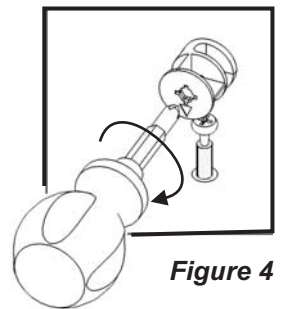

Figure 4

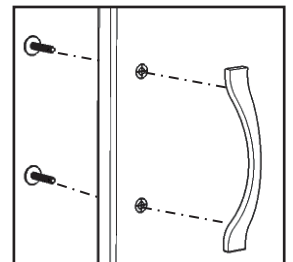

Figure 5

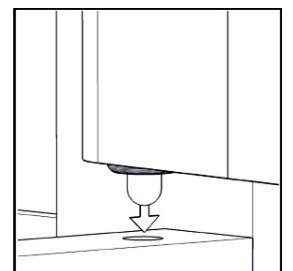

Figure 6

STEP 4

Turn the unit to its' upright position.

Attach Top (A) to the unit with Cam Locks. (See Figure 4)

Assemble Pull Handles to Doors with Machine Screws. (See Figure 5)

Attach Doors (I) and (J) by inserting the lower Spring Pin into the hole unit it clicks
(See Figure 6) and then do the same for the upper Spring Pin.

Slide Drawers (K) into position.

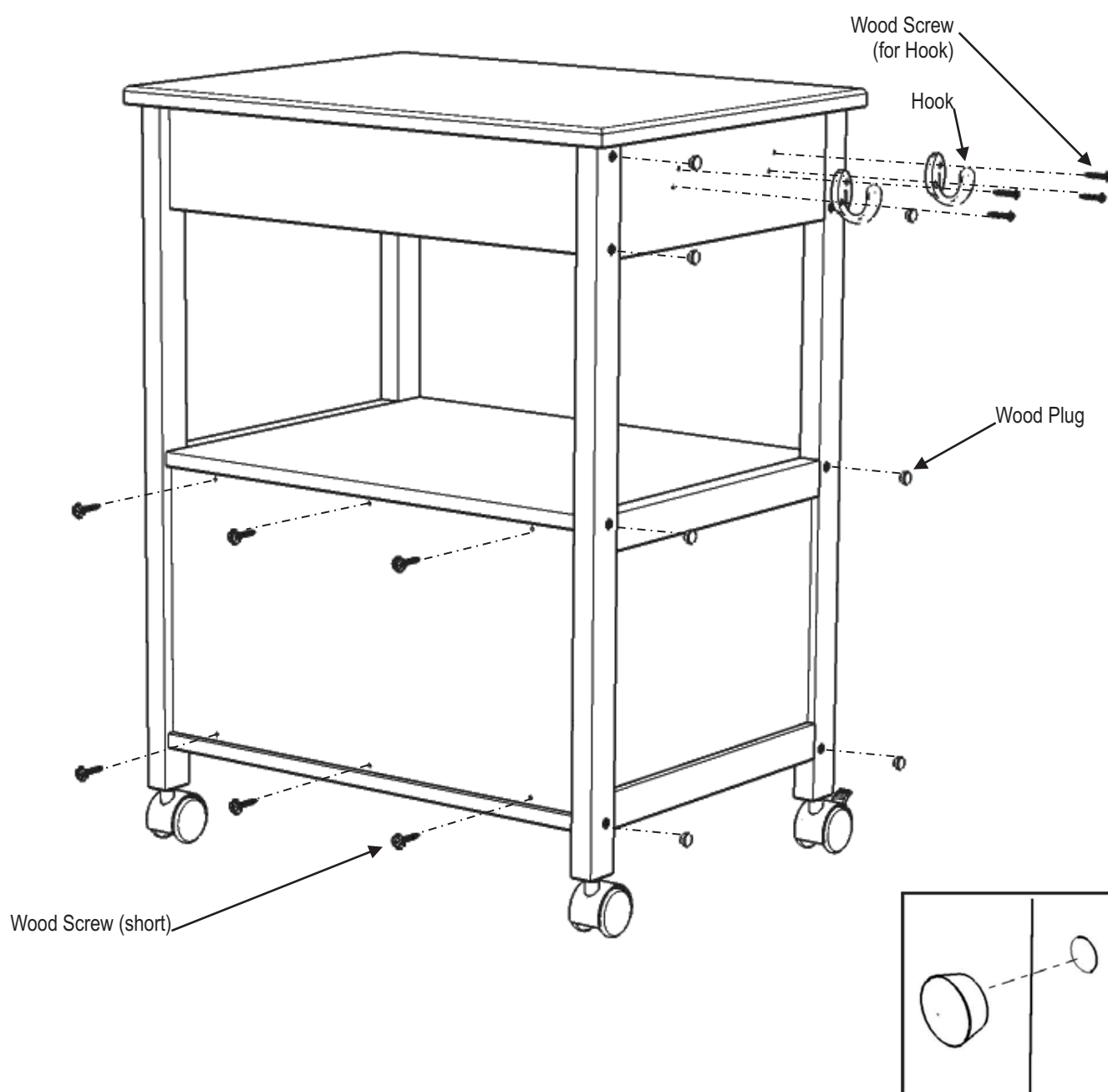

Figure 7

STEP 5

Attach 2x Hooks at the pre-drilled holes of Side Panel (B) with Wood Screw (for Hook).

Insert 6X Wood Screws (short) from the back of the unit, tighten up all the Wood Screws.

Cover up all holes with Wood Plugs. (See Figure 7)

Drawer (K)

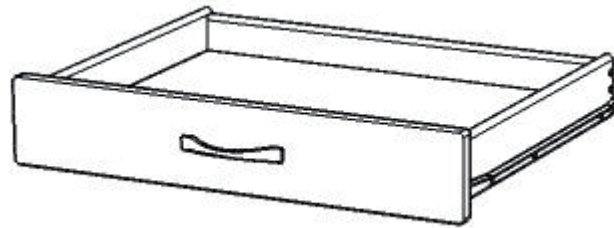

STEP 1

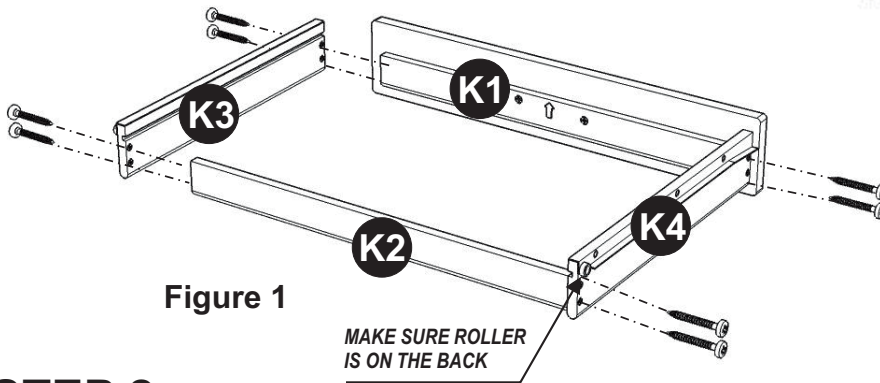

Attach K1 to K3 and K4, using a Phillips screwdriver and long wood screws (4X), tighten halfway.

Attach K2 to K3 and K4 using long wood screws (4X), tighten halfway. (See Figure 1)

STEP 2

Slide K5 into the grooves in K3 and K4. Be sure to push K5 all the way forward so it meets K1. (See Figure 2)

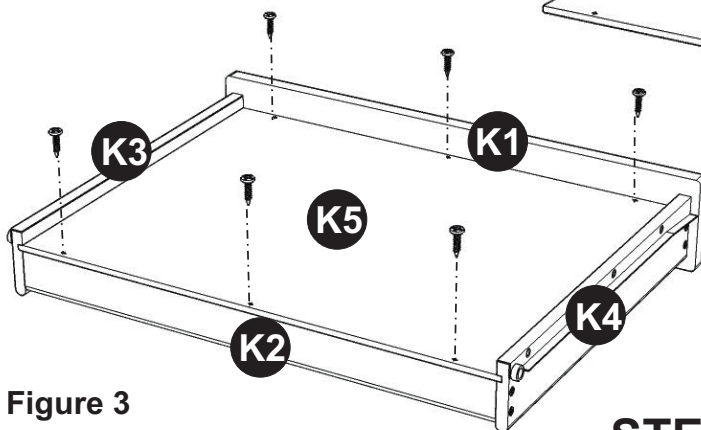
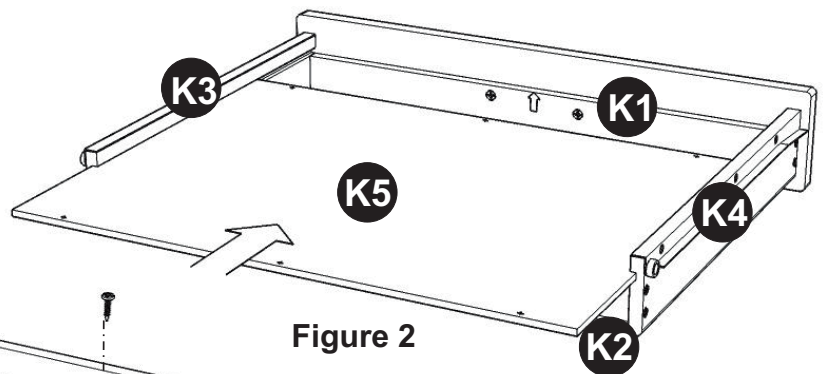

Figure 3

STEP 3

Insert short wood screws (6X) into the pre-drilled holes in K5, tighten screws. (See Figure 3)

STEP 4

Assemble Pull Handle with machine screws. (See Figure 4)

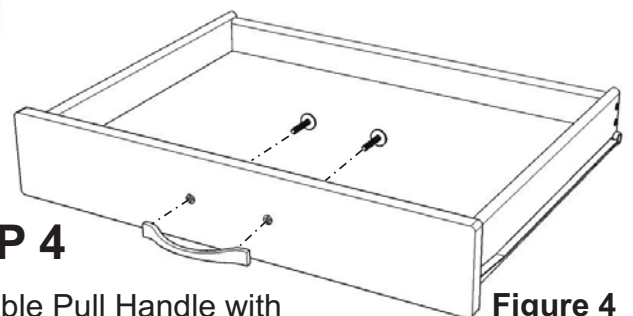

Figure 4

Tighten all screws used in drawer assembly.

Part List

